

SIDES Metres	ANGLES OF DIRECTION	CO-ORDINATES		SG No 669/2010
		Y System	WG 31° X	
	Constants	0,00	+3200 000,00	Approved
AB	47,76 312 17 10	A -4 419,37	+ 91 116,32	<i>Ronald</i> for Surveyor-General 2010.05.28
BC	23,84 51 56 50	B -4 454,70	+ 91 148,46	
CD	43,76 132 17 10	C -4 435,93	+ 91 163,15	
DA	23,50 222 17 10	D -4 403,56	+ 91 133,71	
	277/2931	△ -2 584,61	+ 90 556,84	Ordinance No 27 of 1949 Ref No 2006/285
	286/2931	△ -1 615,14	+ 86 621,46	

SERVITUDE NOTE

The figure AabD represents a Sewer and Drain Servitude 5,00 metres wide

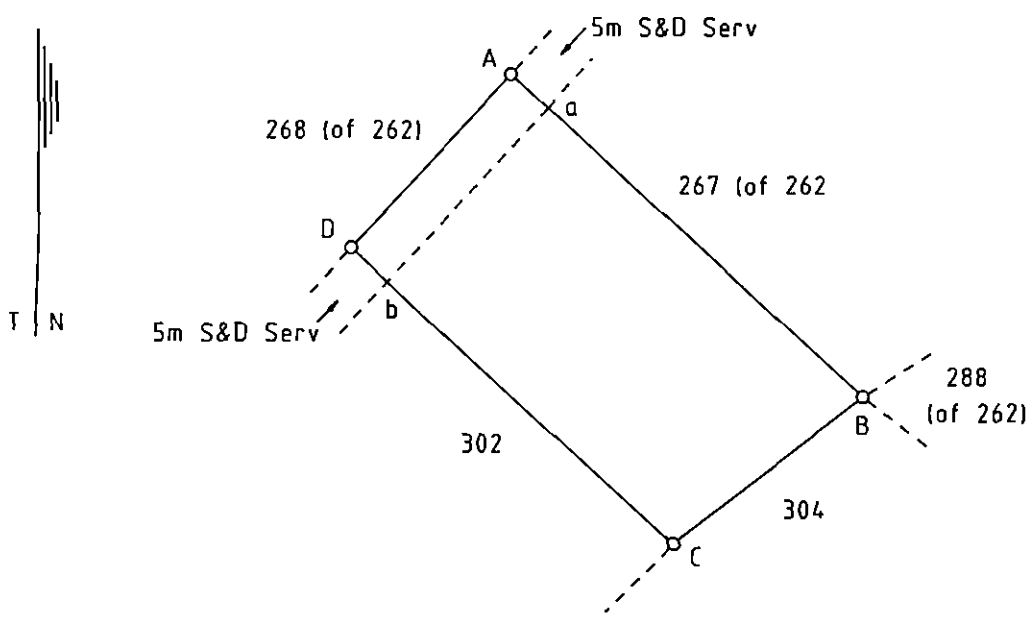

SCALE 1 : 750

BEACON DESCRIPTIONS

A,B,C,D 16mm Iron Peg

The figure A B C D

represents 1075 square metres of land being

PORTION 303 (OF 289) OF ERF 143 MOUNT EDGECOMBE

Situate in the Ethekwini Municipality - North Entity
Registration Division - FU, Province of Kwazulu-Natal

Surveyed in November 2006 - December 2009 by me

R. Singh
R SINGH (PLS 0888)
Professional Land Surveyor

This diagram relates to No T36258/2015 Registrar of Deeds	The original diagram is SG No 655/2010 Transfer No	File No /1 VOL 4 SR No 215/2010 Comp FU-5C-21B,D
---	---	--